

Legend:



DIRIS Digiware U



DIRIS Digiware BCM



Load

Fuse: 0.5 A gG / BS 88 2 A gG
0.5 A class CC

For connection to IT system earthing, adapt the protection in accordance with the installation standards.

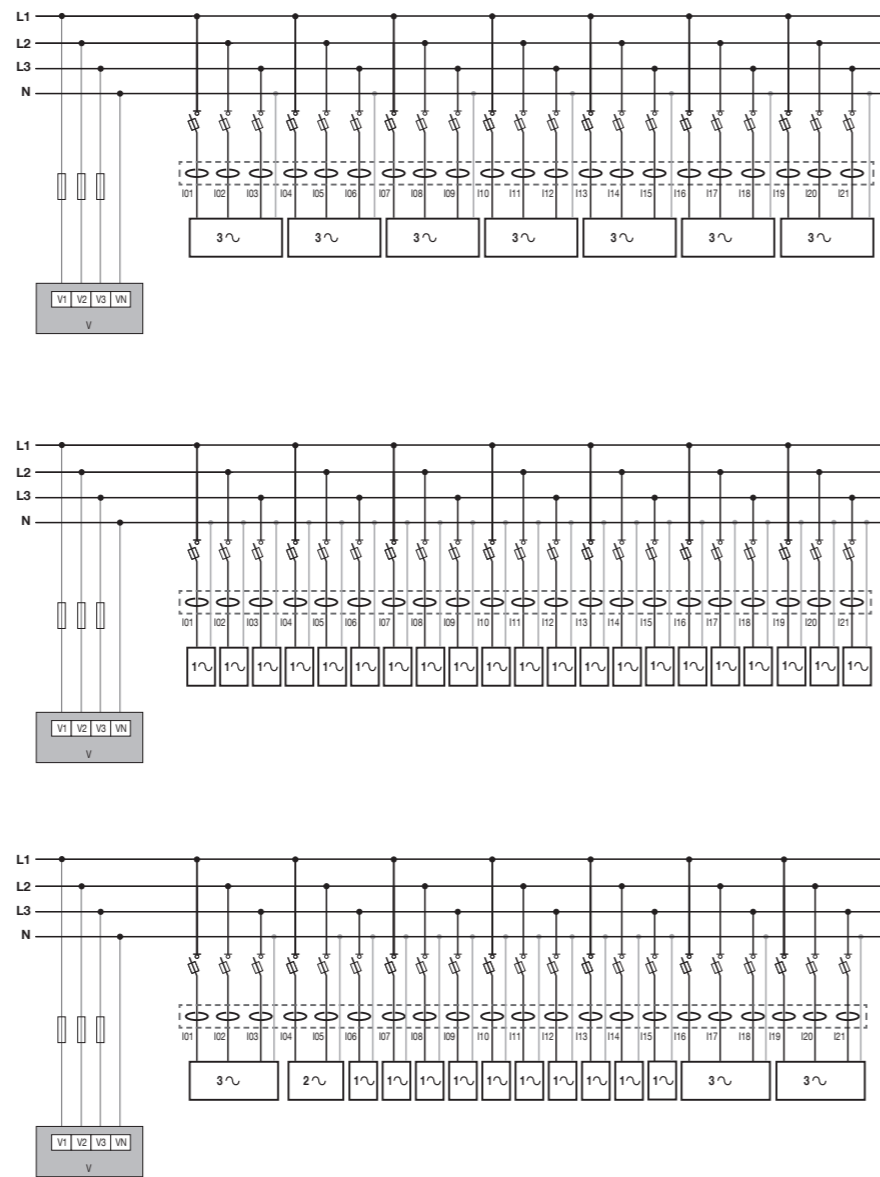

8 Configuration with Easy Config System

USB through D-xx display or M-xx gateway

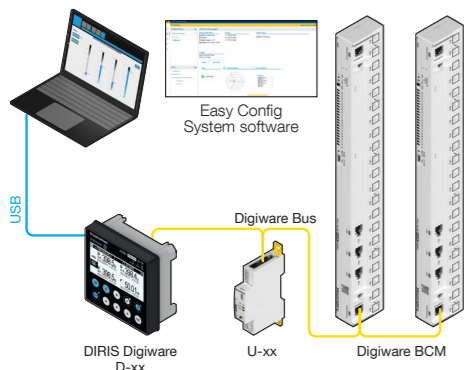

Ethernet through D-xx display or M-xx gateway

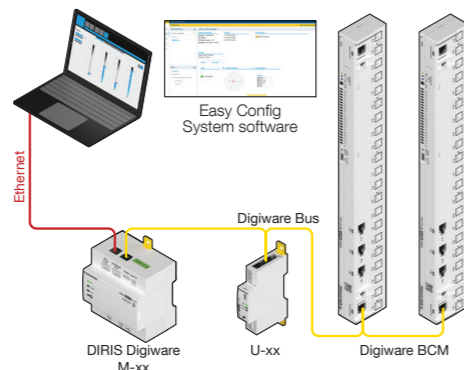

Direct USB

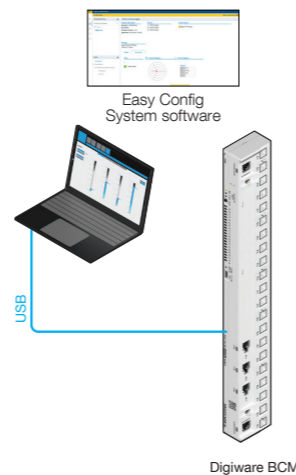

552082A

Branch-circuit Meter – 21 circuits
DIRIS Digiware BCM-21xx

Full manual #542875
Full user manual:
www.socomec.com/en/diris-digiware
www.socomec.com



DIRIS Digiware BCM model	BCM-2119	BCM-2119VM	BCM-2125	BCM-2125VM
# of circuits	21	21	21	21
Pitch	3/4-in (19mm)	3/4-in (19mm)	1-in (25mm)	1-in (25mm)
I _{max}	80 A	80 A	120 A	120 A
Breaker Status		•		•
Part no.	4829 0167	4829 0168	4829 0169	4829 0170

1 System wiring – exploded view

- Use RJ45 Digiware Bus cables (UTP RJ45 straight, twisted pairs, unshielded, AWG24, 300V, cat.III. rated, -20...+70°C / -4...+158°F) between all DIRIS Digiware modules.
- Use SOCOMEC RJ12 cables (UTP unshielded, twisted pair, straight, AWG24, 600V, CATV, -10...+70°C / 14...+158°F).
- Do not put USB or RJ45 connectors in contact with hazardous voltage.

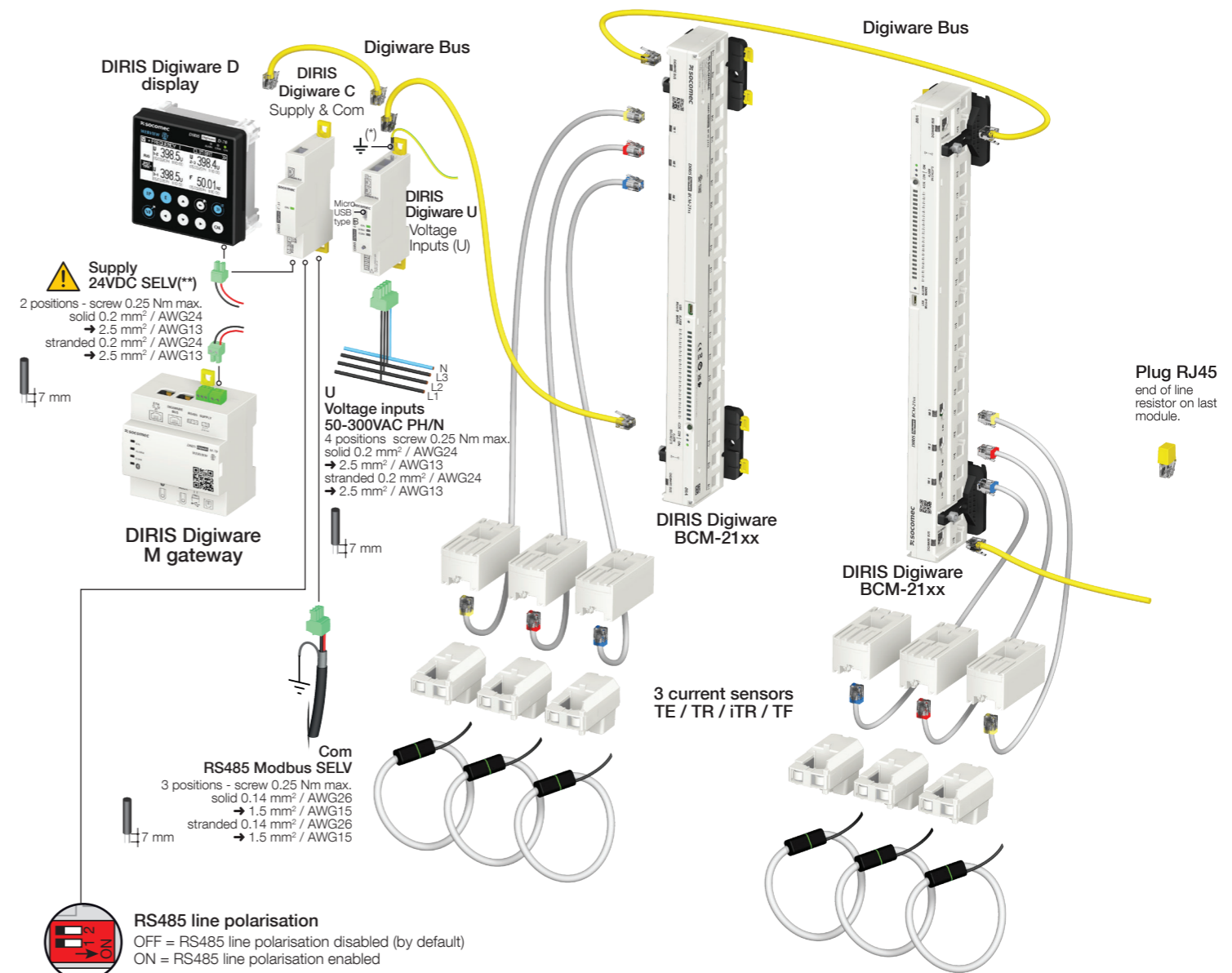

SELV : Safety Extra Low Voltage.
(*) Do not forget to connect earth to the DIRIS Digiware U module.

2 Dimensions (in/mm)

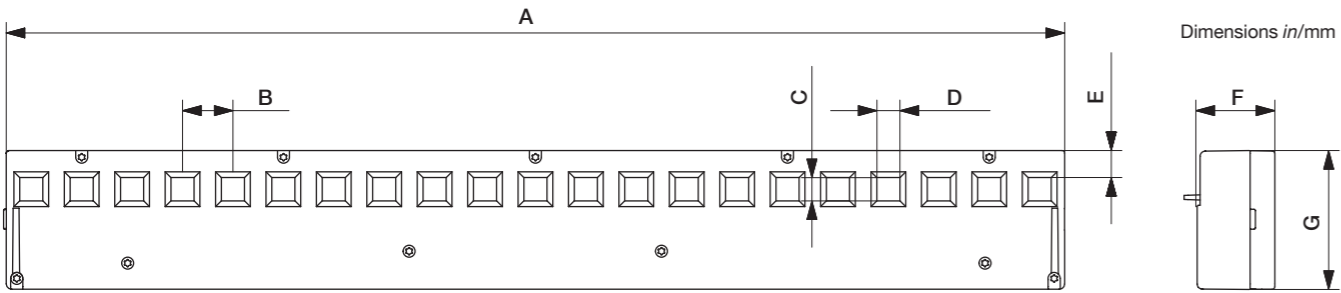

	A	B	C	D	E	F	G
DIRIS Digiware BCM-2119 / 2119VM	15.75 400	0.75 19	0.35 8,8	0.34 8,6	0.39 10	1.18 30	2.09 53
DIRIS Digiware BCM-2125 / 2125VM	20.98 533,5	0.98 25	0.55 14	0.54 13,6	0.75 19	1.26 32	2.68 68

3 Mounting

Back plate

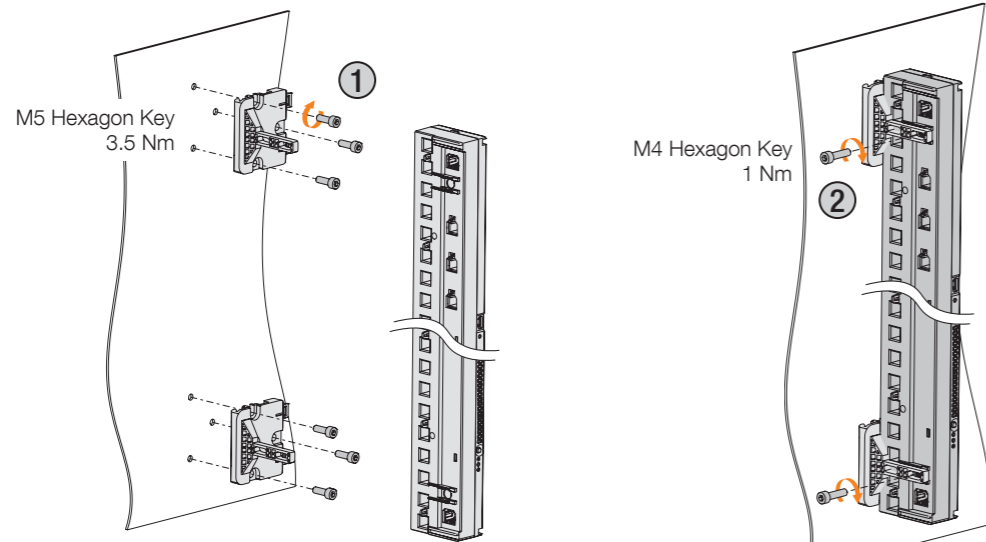

DIN rail

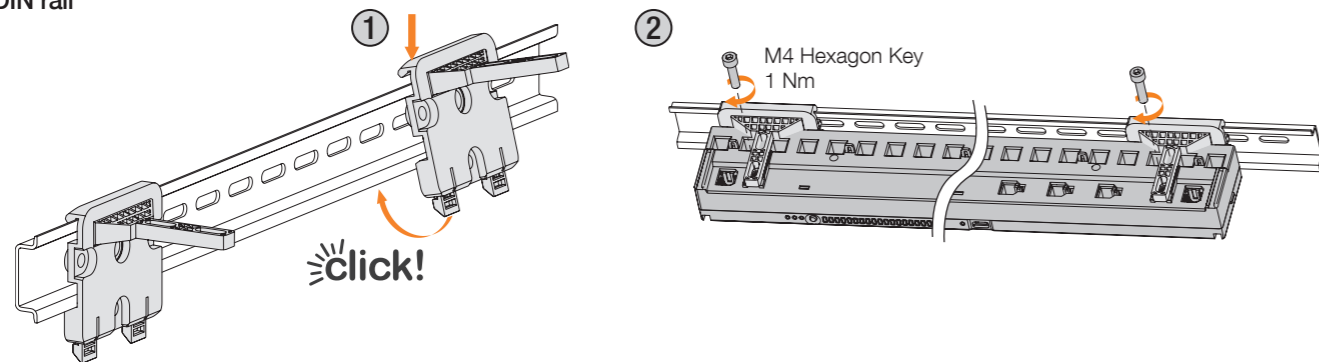

4 HMI

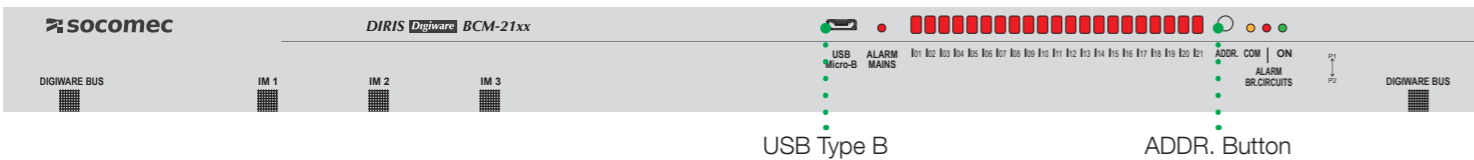

	FIXED	BLINKING
ALARM MAINS (Red)	Ongoing alarm (measurement, protection)	Ongoing system alarm (disconnected CT, V/I association, incorrect CT rating)
I01 - I21 (Red)	Indicates that no voltage is detected on a phase	-
COM (Orange)	Address conflict during Auto-Discovery process	Device is communicating
ALARM BR. CIRCUITS (Red)	Ongoing alarm (measurement, protection)	Ongoing system alarm (disconnected CT, V/I association, incorrect CT rating)
ON (Green)	Product powered and operating normally	When D-xx display is navigating on device and upon manual request (10 sec)

5 Technical characteristics

	DIRIS Digiware BCM-2119	DIRIS Digiware BCM-2125
Measurement characteristics		
Nominal current I_n	32 ... 63 A	40 ... 100 A
Maximum current I_{max}	80 A	120 A
Communication characteristics		
RJ45 Digiware bus	1 x Input / 1 x Output	
Micro USB Type B	Configuration via Easy Config System software and firmware upgrade via Product Upgrade Tool software	
Environmental characteristics		
Use	Indoor	
Storage temperature	-20 ... +70°C / -4 ... +158°F (ANSI C12.1)	
Operating temperature	-10 ... +55°C / 14 ... +131°F (ANSI C12.1)	
Humidity	+25°C / 97% RH & +55°C / 93% RH (ANSI C12.1)	
Operating altitude	≤ 2000 m / 6500 ft	
Pollution degree	2	
Protection class	IP20	
Measurement category	III	
Mechanical characteristics		
Vibration	10 ... 150 Hz, 1 g	
Shock	Half-sine pulse, 15g, 11ms (ANSI C12.1)	
Standards		
Measurement	IEC 61557-12 - Class 0.5 for active energy IEC 62053-21 - Class 0.5 for active energy ANSI C12.20 - Class 0.5 for active energy	
Safety	UL/CSA 61010-1 & 61010-2-030 Guide FTRZ/PICQ File E257746	

6 Panelboard view

Left-side

	Input Number *	Default 3-Phase assignment	CT Way **
Mains	IM1	A / 1	P1 → P2
	IM2	B / 2	P1 → P2
	IM3	C / 3	P1 → P2
	I01	A / 1	P1 → P2
	I02	B / 2	P1 → P2
	I03	C / 3	P1 → P2
	I04	A / 1	P1 → P2
	I05	B / 2	P1 → P2
	I06	C / 3	P1 → P2
	I07	A / 1	P1 → P2
Branches	I08	B / 2	P1 → P2
	I09	C / 3	P1 → P2
	I10	A / 1	P1 → P2
	I11	B / 2	P1 → P2
	I12	C / 3	P1 → P2
	I13	A / 1	P1 → P2
	I14	B / 2	P1 → P2
	I15	C / 3	P1 → P2
	I16	A / 1	P1 → P2
	I17	B / 2	P1 → P2
	I18	C / 3	P1 → P2
I19	A / 1	P1 → P2	
I20	B / 2	P1 → P2	
I21	C / 3	P1 → P2	

TE/TR/ITR/TF
Current sensors

Right-side

	Input Number *	Default 3-Phase assignment	CT Way **
Branches	I21	A / 1	P1 → P2
	I20	B / 2	P1 → P2
	I19	C / 3	P1 → P2
	I18	A / 1	P1 → P2
	I17	B / 2	P1 → P2
	I16	C / 3	P1 → P2
	I15	A / 1	P1 → P2
	I14	B / 2	P1 → P2
	I13	C / 3	P1 → P2
	I12	A / 1	P1 → P2
	I11	B / 2	P1 → P2
Mains	I10	C / 3	P1 → P2
	I09	A / 1	P1 → P2
	I08	B / 2	P1 → P2
Mains	I07	C / 3	P1 → P2
	I06	A / 1	P1 → P2
	I05	B / 2	P1 → P2
Mains	I04	C / 3	P1 → P2
	I03	A / 1	P1 → P2
	I02	B / 2	P1 → P2
Mains	I01	C / 3	P1 → P2
	IM3	C / 3	P1 → P2
	IM2	B / 2	P1 → P2
IM1	A / 1	P1 → P2	

DIRIS Digiware BCM DIRIS Digiware BCM

Warning: When installing the DIRIS Digiware BCM in a right-side configuration, default phase assignment must be changed in Easy Config System software.

Warning: For direct current inputs, install on 300 V insulated cable only.
 (*) Refer to product marking for input number.
 (**) CT Way can be changed in Easy Config System software if necessary.